

Flat Glass Ice Cream Freezer

Model	Size	Refrigerant
SD-302	9.0 Cu-Ft	R290



Model Shown SD-142

STANDARD FEATURES

- CFC free refrigerant and 2.5" foam insulation
- Mechanical Thermostat adjust from -15°F to 8°F
- Drainage is in rear
- Fast freeze time
- Flat Sliding Glass Doors-Top LOW-E Tempered Glass for easy view. Locks & Keys included.
- Low noise level
- Internal coved corners, easy to clean
- Removable PVC coated basket included for easy organizing
- Big casters for easy moving
- Manual Defrost
- Uses R290 refrigerant, which is eco-friendly and more efficient
- Warranty: 1 year parts and labor

FREEZERS

*Not suitable for installation in a non-commercial or residential applications.

Items	Description
External top/side	Flat Glass Sliding Door
Door	LOW-E Tempered Glass w/Lock
External back	White Precoated Steel
Cabinet internal	Embossed Aluminum
Internal floor	Embossed aluminum
Insulation	2.5" foam
Lighting	None



CONFORMS TO UL STD.NO.60335-2-89
 CERTIFIED TO CSA STD. C22.2 NO.60335-2-89
 CONFORMS TO NSF STD.7

Items	Description
Temperature control	Mechanical 1 to 7
Comply to standard	ANSI / NSF-7
Refrigerating system	Capillary tube
Refrigerant	R290
Temperature	-15°F to 8°F
Evaporator/Condenser	Aluminum + Copper
Condensing unit	Side mount



DETAILS AND DIMENSIONS

Schematic Drawing

SD-302

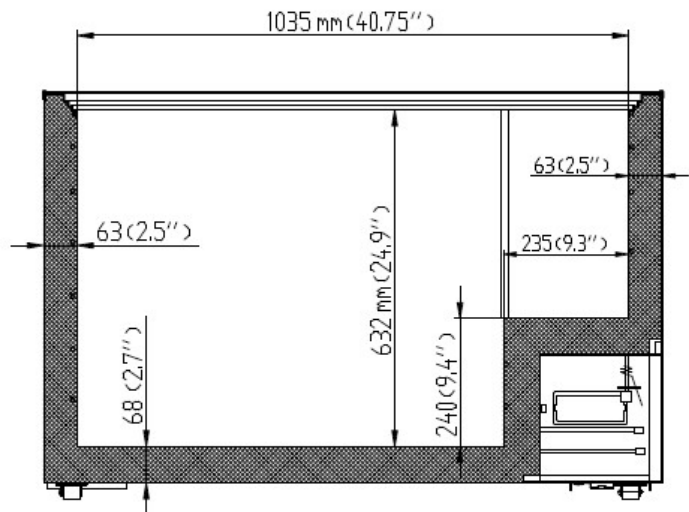
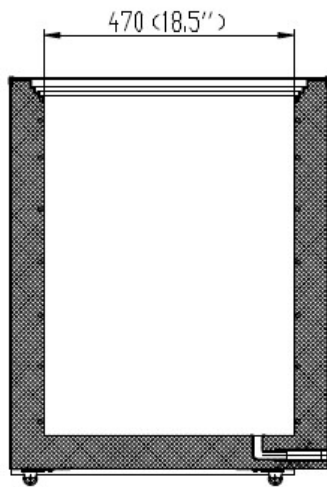
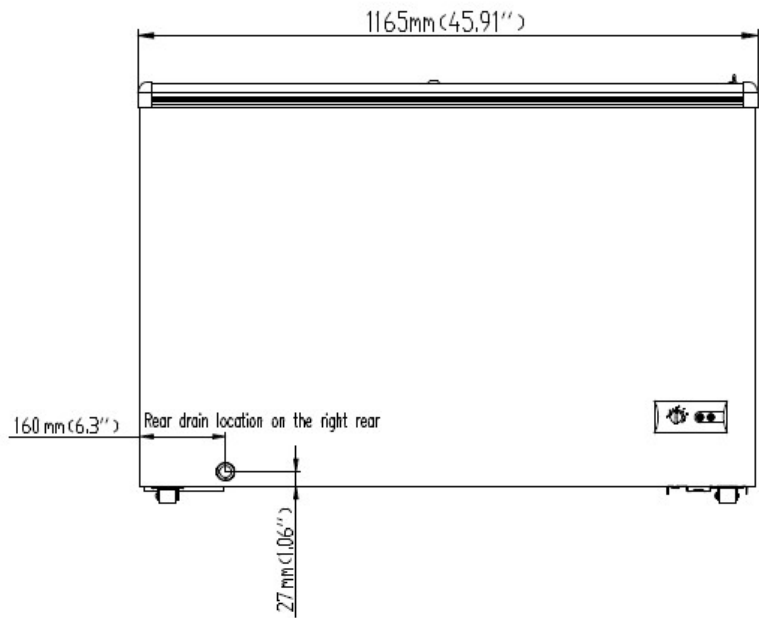
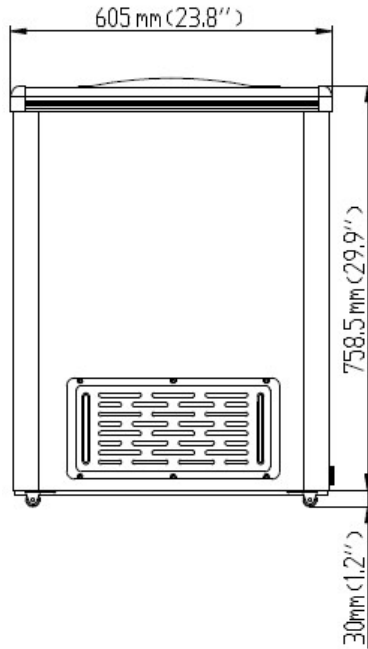

Model	# of Baskets	Appx. Storage Cap. (Cu/Ft)	Cabinet Dim (in)			HP	Voltage /Hz /ph	Amp	NEMA Plug	Cord Lgth (ft)	Uncrated / Crated Weight
			W	D	H						
SD-302	3	9.0	45.91	23.8	31.1	1/3	115/60/1	3.0	5-15P	6	99/110