

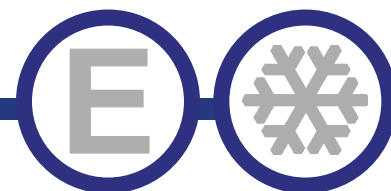

# Series "A"



## GLASS FROSTER



EGF24-HC



EGF36-HC

Model	Width
EGF24-SI-HC	24.0"
EGF36-SI-HC	36.8"

### STANDARD FEATURES

- CFC free refrigerant and foam with self contained capillary tube system
- Forced-air cooling
- Shelves Provided
- Self-Defrosting Evaporator
- Bottle cap opener & cap catcher standard
- Locking Doors
- Certified to ANSI / NSF7 standards
- Four 1" Fixed Rollers
- **Now with LED Lighting**
- Warranty: 2 Years Parts & Labor, 3 additional years on compressor
- Measured Efficiency: EGF24-HC 1.13kW h/day  
EGF36-HC 1.19kW h/day

\*Not suitable for installation in a non-commercial or residential applications.

Items	Description	Items	Description
External top/side	Stainless steel	Temperature control	Solid State T-stat with Digital Display
Door	Stainless steel	Comply to standard	ETL LISTED, ANSI / NSF-7
External back	Steel painted black	Refrigerating system	Capillary tube
Cabinet internal	430 stainless steel	Refrigerant	R600a
Internal floor	304 stainless steel	Temp. Range in box	-4°F — -5°F
Insulation	Polyurethane (CFC free)	Evaporator/Condenser	Aluminum + Copper
Shelving	Heavy duty, Epoxy coating	Condensing unit	Bottom Mount
Lighting	LED Lighting	Doors	Sliding Doors

GLASS FROSTERS



# DETAILS AND DIMENSIONS

\*Not suitable for installation in a non-commercial or residential application

## EGF24-SI-HC

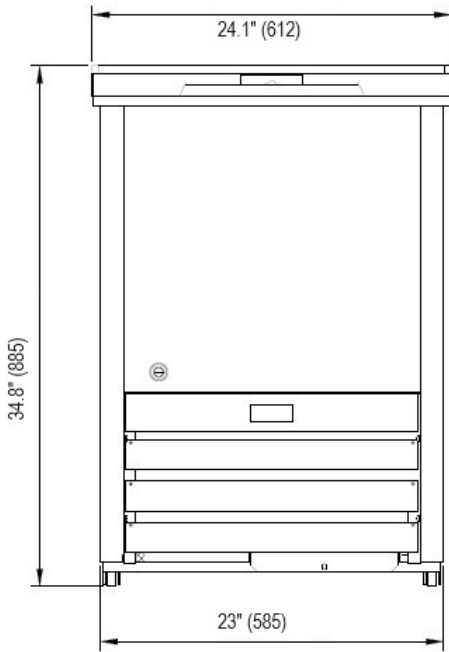

Front View

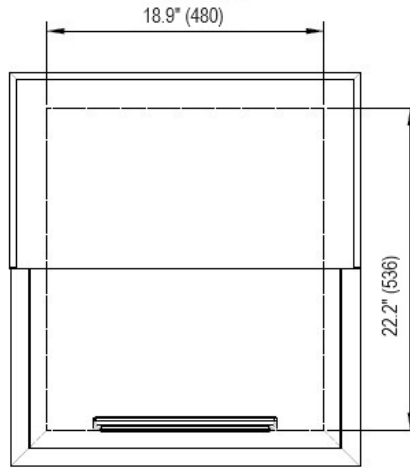

Top View

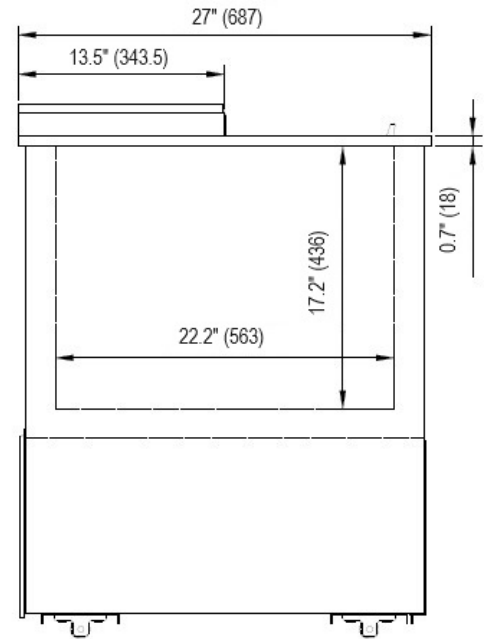

Side View

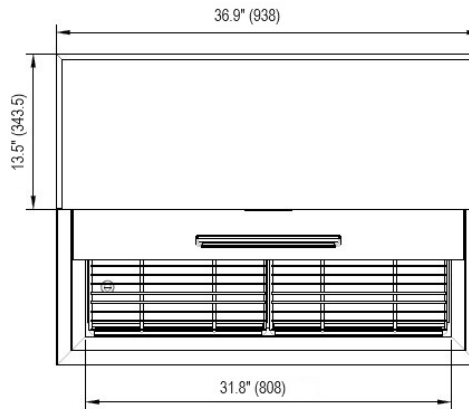
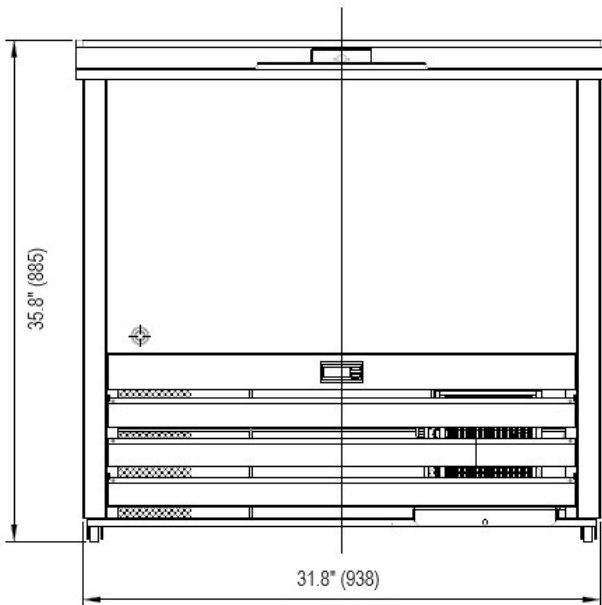

## EGF36-SI-HC

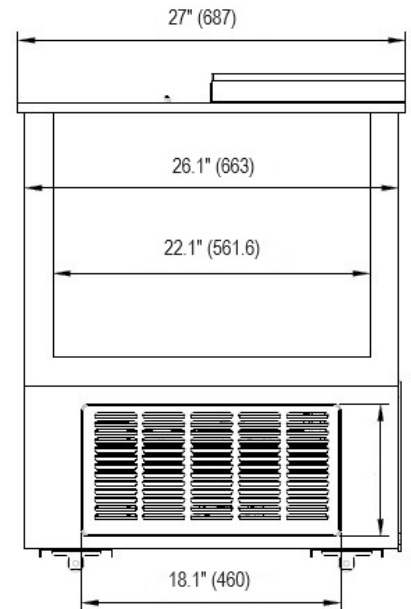

Model	# of Lids	Shelves	Cabinet Dim (in)			HP	Voltage /Hz /ph	Amp	NEMA Plug	Cord Lgth (ft)	Crated Weight (lbs)
			W	D	H						
EGF24-SI-HC	1	3	24.1	27	34.8	1/5	115/60/1	2.0	5-15P	8.2	250
EGF35-SI-HC	1	4	36.9	27	34.8	1/5	115/60/1	2.0	5-15P	8.2	380