

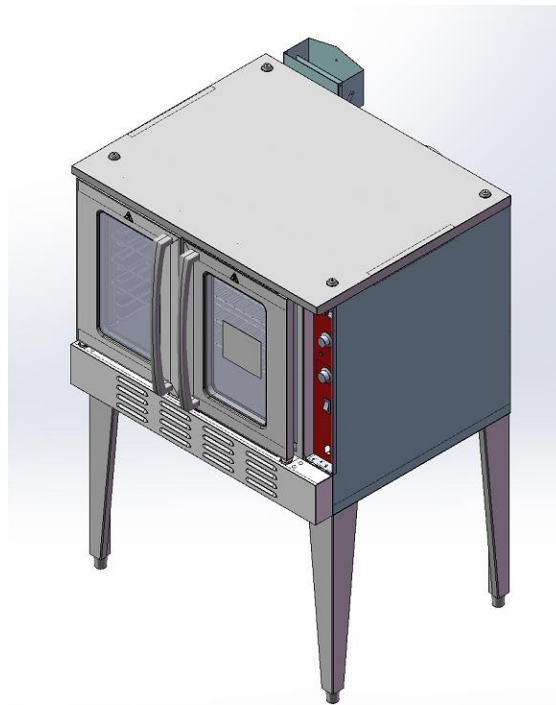

INSTALLATION & OPERATION MANUAL GAS CONVECTION OVEN



⚠ WARNING

This manual contains important information regarding your Entrée unit. Please read the manual thoroughly prior to equipment set-up, and operation maintenance. Failure to comply with regular maintenance guidelines out-lined in the manual may void the warranty. Improper installation, adjustment, alteration, service or maintenance can cause property damage, injury or death. Read this manual thoroughly before installing or servicing this equipment.

MUST READ!

**Entrée LLC
4673 OSBORNE DR., SUITE I
EL PASO, TX 79922**

Technical Support: 570-752-4602



Customer Service: 570-497-5477

Register your product warranty online at: www.entree.biz

SAFETY PRECAUTIONS

Before installing and operating this equipment, be sure everyone involved in its operation is fully trained and aware of precautions. Accidents and problems can be caused by failure to follow fundamental rules and precautions.

The following symbols, found throughout this manual, alert you to potentially dangerous conditions to the operator, service personnel, or to the equipment.

	This symbol refers to a potential hazard or unsafe practice that could result in injury or death.
	This symbol refers to a potential hazard or unsafe practice that could result in injury, product damage, or property damage.
	This symbol refers to information that needs special attention or must be fully understood, even though not dangerous.

FOR YOUR SAFETY TO AVOID SERIOUS PERSONAL INJURY AND PROPERTY DAMAGE:

- **ALWAYS** install equipment in a work area with adequate light and space.
- **ONLY** operate on a solid, level, nonskid surface that is nonflammable and away from sinks and water hazards.
- **NEVER** bypass, alter, or modify this equipment in any way from its original condition. Doing so may create hazards and will void warranty.



FIRE HAZARD FOR YOUR SAFETY

Do not store or use gasoline or other flammable vapors and liquids in the vicinity of this or any other appliance. Keep area around appliances free and clear of combustibles. Purchaser of equipment must post in a prominent location, detailed instructions to be followed in the event the operator smells gas. Obtain the instructions from the local gas supplier



Entrée Convection Ovens are intended for commercial use only. Not for household use. Warranty will be void if service work is performed by other than an authorized technician, or if other than genuine Entrée replacement parts are installed. Be sure this Operator's/Installer's Manual and important papers are given to the proper authority to retain for future reference.

**For warranty Service on your Entrée Gas Convection Oven call 866-417-6410
Be sure to have your model and serial number when calling.**

Congratulations! You have purchased one of the finest pieces of commercial cooking equipment on the market. You will find that your new equipment, like all Entrée equipment, has been designed and manufactured to meet the toughest standards in the industry. Each piece of Entrée equipment is carefully engineered and designs are verified through laboratory tests and field installations. With proper care and field maintenance, you will experience years of reliable, trouble-free operation. For best results, read this manual carefully.

RETAIN THIS MANUAL FOR FUTURE REFERENCE

Table of Contents

Specifications -----	Page 3 & 4
Installation-----	Page 5
Operation-----	Page 10
Cleaning-----	Page 12
Wire Schematic-----	Page 12
Parts-----	Page 14
Warranty-----	Page 16

Read these instructions carefully before attempting installation. Installation and initial startup should be performed by a qualified installer. Unless the installation instructions for this product are followed by a qualified service technician (a person experienced in and knowledgeable with the installation of commercial gas and/or electric cooking equipment) then the terms and conditions on the Manufacturer's Limited Warranty will be rendered void and no warranty of any kind shall apply.

SPECIFICATIONS

GAS and GAS PRESSURE

⚠ CAUTION This unit is factory supplied in Natural Gas. This unit can be converted to L.P. gas by a licensed and certified gas technician. Documentation will be necessary for warranty issues. Failure to comply with this instruction will void warranty. **See the included L.P. conversion kit for gas conversion parts and instructions in separate publication.**

⚠ WARNING Unit installation must conform to the National Fuel Gas Code, ANSI Z223.1/NFPA 54, the National Gas Installation Code, CSA-B149.1, or the Propane Installation Code, CSA-B149.2 as applicable and in accordance with local codes.

⚠ WARNING The appliance and it's individual shutoff valve (to be supplied by user) must be disconnected from the gas supply piping system during any pressure testing of that system at test pressures in excess of 1/2" P.S.I. (3.45kPa).

These models are designed, built, and sold for commercial use only.

If using a flexible hose, the I.D. (inside diameter) should not be smaller than 3/4" and must comply with ANSI Z 21.69.

Instructions must be posted in a prominent location. All safety precautions must be taken in the event the user smells gas. Safety information can be obtained from your local gas supplier.

SPECIFICATIONS (Continued)

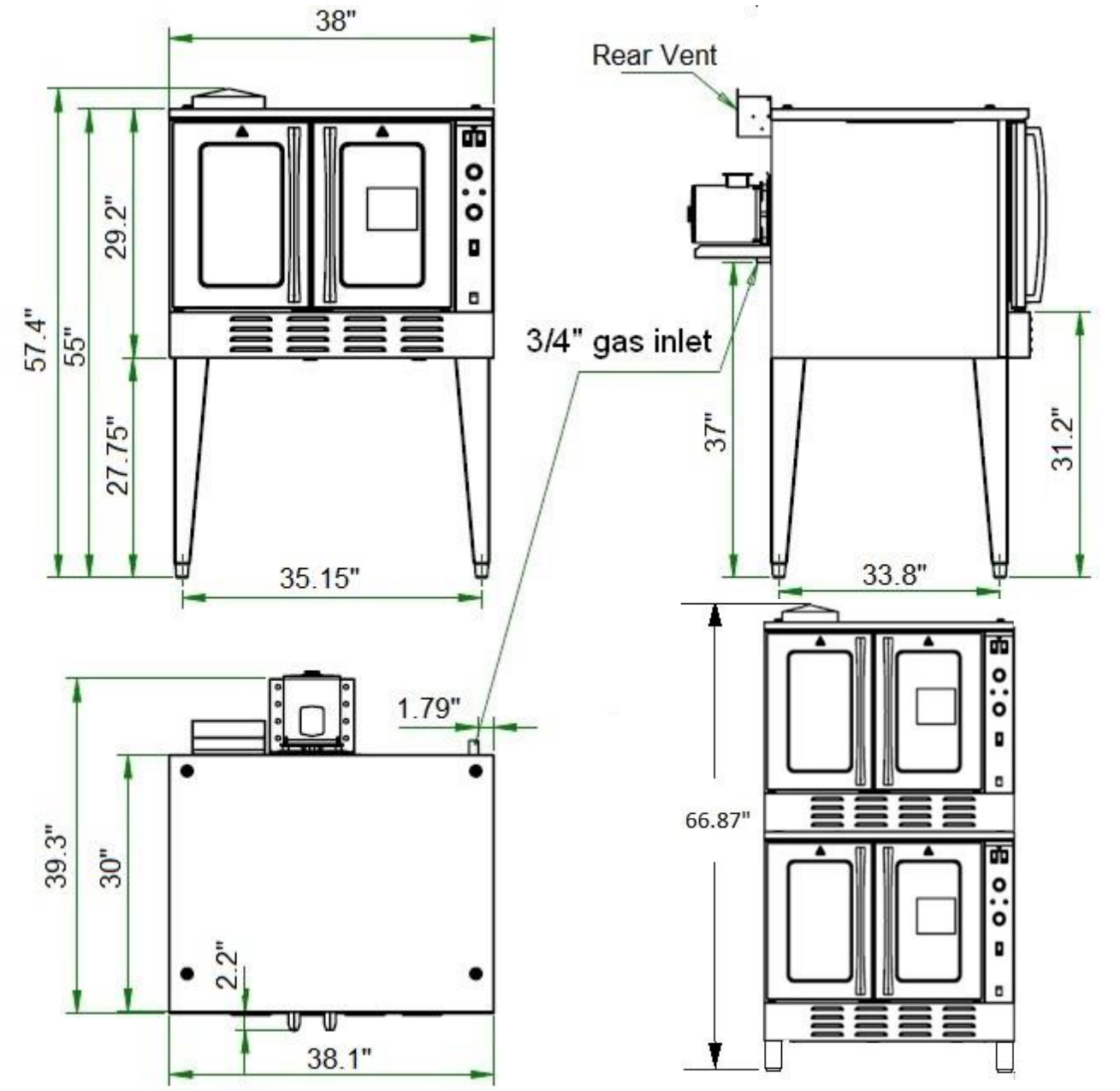

Model	Racks	BTU.hr	Voltage	Amps	External Dims	Internal Dims
CO1-N	5	54,000	120 VAC	9.3	41"W x 39"D x 60"H	28.5"W x 21.5"W x 20"H
CO1-P	5	54,000	120 VAC	9.3	41"W x 39"D x 60"H	28.5"W x 21.5"W x 20"H
CO2-N	10	2 X 54,000	120 VAC	9.3 EA	41"W x 39"D x 66.87"H	28.5"W x 21.5"W x 20"H
CO2-P	10	2 X 54,000	120 VAC	9.3 EA	41"W x 39"D x 66.87"H	28.5"W x 21.5"W x 20"H

***Rear Wall Clearance from back of motor: TWO INCHES (2") MINIMUM, Side Clearance; 6" Side both sides from Combustible Walls.**

***Casters not available for single deck models.



UNPACKING

Unpack the Gas Convection Oven immediately after receipt. Remove the Gas Convection Oven from the crate; remove all packaging on and surrounding the unit and be certain to remove all protective plastics and residues from all surfaces. Make sure that all parts provided located. Equipment must have the legs and/or casters properly installed before use. Before using this equipment it must be cleaned and dried thoroughly.

INSTALLATION

NOTE: it is vital that the purchaser of this equipment post in a prominent location instructions to be followed in the event that the user smells gas. This information shall be obtained by consulting the local gas supplier. The purchaser of this equipment must post in a prominent location.

1. Read this manual thoroughly before installation and operation. DO NOT proceed with installation and operation if you have any questions or do not understand anything in this manual. Contact your local representative or Entrée first.
2. Select a location for the Gas Convection Oven that has a level, solid, nonskid surface that is nonflammable and away from water hazards or sinks, and is in a well-lighted work area away from children and visitors.
3. This equipment **MUST** be installed under a proper ventilation as required by local code.
***NOTICE** Local codes regarding installation and ventilation vary greatly by area. The National Fire Protection Association states in its NFPA 96 latest edition (see NFPA page at the beginning of this manual) that local codes are “authority having jurisdiction” when it comes to requirements for installation of equipment. Therefore, installation should comply with all local codes.
4. Attach legs into permanently fastened nuts on the four corners of the unit and tighten. Legs must be installed to adequately provide proper ventilation to the unit.
5. Level unit **to the center oven rack** by adjusting the four feet and tighten securely. The adjustable feet have an adjustment of one inch. Do not slide unit with legs mounted. Lift if necessary to move unit.
6. The supplied gas pressure regulator is factory set at 4” Natural Gas W.C. or 10” Propane Gas.
7. THESE UNITS ARE SUITABLE FOR INSTALLATION ON NON-COMBUSTIBLE SURFACE ONLY. Noncombustible clearances: 2” sides (152 mm), 2” rear (152 mm), 6” floor (152 mm).
8. Do not obstruct the flow of combustion and ventilation air under the unit by the legs or behind the unit by the flue.
9. There must be adequate clearance for removal of the front and right side panel. All major parts except the burners are removable through the front if the gas is disconnected.
10. Pipe threading compound must be resistant to the action of liquefied petroleum gas.
DO NOT USE TEFLON TAPE.

⚠WARNING DO NOT use an open flame to check for leaks. Check all gas piping for leaks with a soap and water solution before operating the unit.

The installation of this appliance must conform to local codes, or in the absence of local codes, the National Fuel Gas Code, ANSI Z223.1/NFPA 54, or the Natural Gas and Propane Installation Code, CSA B149.1, as applicable.

- The appliance and its individual shut off valve must be disconnected from the gas supply piping system during any pressure testing of that system at test pressures in excess of ½ PSI (3.5kPa).
- The appliance must be isolated from the gas supply piping system by closing its individual manual shut off valve during any pressure testing of the gas supply piping system at test pressures equal to less than ½ PSI (3.5kPa).

Clearance and positioning around the appliance: This appliance must be installed adjacent to non-combustible surfaces only with a minimum spacing of six (2") inches from sides and two (2) inches from rear of convection oven motor. The appliance must have the supplied four legs installed and be placed on a non-combustible surface. Air necessary for the burner combustion is equal to 2 cum/h per each kW of installed power. Do not locate the oven adjacent to any high heat or grease-producing piece of equipment, such as a range top, griddle, fryer, etc., that could allow radiant heat to raise the exterior temperature of the oven above 130°F (54°C). Do not mount above other cooking equipment.

Air supply and ventilation: The area in front and around the appliances must be kept clear to avoid any obstruction of the flow of combustion and ventilation air. Adequate clearance must be maintained at all times in front and at the sides of the appliance for servicing and proper ventilation.

Pressure Regulator: All commercial cooking equipment must have a pressure regulator on the incoming service line for safe and efficient operation. The regulator provided for this appliance is adaptable for both Natural Gas and Liquefied Propane (LP) Gas. A conversion kit with separate instructions is included explaining this procedure in detail.

Regulator information: 3/4" NPT (National Pipe Thread) inlet and outlet; factory adjusted for four (4") inch Water Column (WC) Natural Gas standard and may be converted by qualified personnel to be used for Propane at ten (10") Water Column pressure.

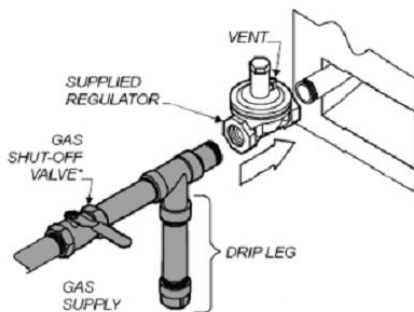

Connection diagram

Prior to connecting the regulator, check the incoming line pressure. The regulator can only withstand a maximum pressure of 1/2 PSI (14" WC). If the line pressure is beyond this limit, a step down regulator before the regulator provided will be required. The arrow forged into the bottom of the regulator body shows gas flow direction, and should point downstream to the appliance.

Gas Connection: The serial plate is located inside the lower front panel. It indicates the type of gas the unit is equipped to burn. All our equipment is adjusted at the factory. Check type of gas on serial plate. The appliance comes fitted with a 3/4" NPT (National Pipe Thread) male adapter for connection to the pressure regulator. The appliance is design-certified for operation on natural or propane gases, it should be connected only to the type of gas for which it is equipped.

Maintenance: A qualified service company should check the unit for safe and efficient operation on an annual basis. Contact the factory representative or local service company to perform maintenance and repairs.

Gas Piping: Gas piping shall be of such size and so installed as to provide a supply of gas sufficient to meet the full gas input of the appliance. If the appliance is to be connected to existing piping, it shall be checked to determine if it has adequate capacity. Joint compound (pipe dope) shall be used sparingly and only on the male threads of the pipe joints. Such compounds must be resistant to the action of Liquefied Propane (LP) gases.

CAUTION Any loose dirt or metal particles, which are allowed to enter the gas lines on this appliance, will damage the valve and affect its operation. When installing this appliance, all pipe and fittings must be free from any internal contaminates. It is recommended that a "drip leg" be installed in-line before the regulator.

Manual Shut Off Valve: A manual shut off valve should be installed upstream from the manifold, within four (4) feet, (1.2M) of the appliance and in a position where it can be reached in the event of an emergency.

Checking For Gas Leaks: Using a gas leak detector or a soapy water solution is recommended for locating gas leaks. Check entire piping system for leaks. **DO NOT USE AN OPEN FLAME** Matches, candle flame, or other sources of ignition shall not be used for this purpose of checking for gas leaks

Exhaust Canopy: Cooking appliances inherently create a good deal of heat and smoke and should be installed under an efficient exhaust hood with flame proof filters. A vertical distance of not less than four (4) feet shall be provided between the top of the appliance and filters or any other combustible material.

⚠️WARNING FIRE DEATH HAZARD If you smell gas follow the instruction provided by the gas supplier. Do not touch any electrical switch; do not try to light the burner; do not use a telephone within close proximity.

NOTE: Smoke appearing on initial use of the appliance is normal. This is a result of the rust preventative coating burning off. This will occur for at least fifteen (15) minutes during the first use or seasoning process.

Electric Connection: Before connecting the appliance to the outlet, check the following:

- Voltage corresponds to the data written on the data plate.
- Proper ground is present

⚠️WARNING
The appliance, when installed, must be electrically grounded in accordance with local codes, or in the absence of local codes, with the National Electrical Code, NFPA 70, or the Canadian Electrical Code, CSA C22.2

COMMISSIONING: Commission of your new Convection Oven is of the utmost importance. Commissioning is the thorough and methodical testing of the equipment, subsystems, and systems to ensure that the final product functions properly and safely at the work site. By identifying any potential problems (i.e.: equipment location, ventilation, local fire/electrical codes, installation, operator training, and certification) prior to equipment being placed into service, costly outages and potential damages may be avoided.

⚠️WARNING FIRE, INJURY or DEATH HAZARD This appliance is for use in non-combustible location only

⚠️WARNING FIRE HAZARD
Do not install or use without legs. Use of this equipment without legs can cause the appliance to overheat and cause a fire.

⚠️WARNING Improper installation, adjustment, alteration, service or maintenance can cause property damage, injury or death. Read the installation, operating and maintenance instruction thoroughly before installing or servicing this equipment.

⚠️WARNING FIRE, INJURY or DEATH HAZARD
This equipment must be installed by a qualified installer in accordance with all federal, state and local codes. Failure to install this equipment properly can result in injury or death.

⚠️ WARNING FIRE and INJURY or DEATH HAZARD

Injuries or death can occur if this equipment is not used properly. To reduce risk of injury or death:

- Keep the appliance area free and clear from combustibles
- Do not obstruct the flow of combustion and ventilation air
- Do not spray controls or the outside of the appliance with liquids or cleaning agents
- Let hot appliance cool before cleaning or moving
- The appliance should only be used in a flat, level position
- Do not operate unattended

INSTALLATION OF RESTRAINT (Only for Ovens with Casters)

NOTICE

For an appliance equipped with casters, (1) the installation shall be made with a connector that complies with the **Standard for Connectors for Movable Gas Appliances, ANSI Z21.69** or **Connectors for Moveable Gas Appliances CAN/CGA-6.16**, and a quick-disconnect device that complies with the **Standard for Quick-Disconnect Devices for Use With Gas Fuel, ANSI Z21.41**, or **Quick Disconnect Devices for Use with Gas Fuel, CAN1-6.9**, (2) adequate means must be provided to limit the movement of the appliance without depending on the connector and the quick disconnect device or its associated piping to limit the appliance movement and (3) the restraining means should be attached to a frame member on the back of the unit. **Do not connect restraint to the any gas piping!**

⚠️ WARNING

To avoid accidental gas disconnection and potential explosion: If disconnection of this restraint is necessary to move the appliance for cleaning, etc., reconnect it when the appliance is moved to its originally installed position

IMPORTANT SAFEGUARDS & SAFETY INSTRUCTIONS

⚠️ CAUTION When using gas cooking equipment, basic safety precautions should always be followed, including the following:

The Convection Oven outside surfaces may become HOT after use. Use caution when touching the unit.

- Never directly touch the cooking surface while the Convection Oven is on.
- Always turn off the unit when not in use, servicing or adjusting any parts or attachments, and before cleaning.
- Never leave the Convection Oven on overnight.
- Do not operate any equipment with a damaged or leaking gas line, ignitor or valve, or if the unit is dropped or damaged in any manner. Call for Service.
- The use of attachments not recommended or sold by the manufacture may cause fire, injury or even death.
- DO NOT USE OUTDOORS.
- Do not use this equipment for any use other than the use intended by the manufacturer.
- Never use the Convection Oven as a heating source.
- The Convection oven does not contain **any** user-serviceable parts. Dealer or recommended qualified technicians should carry out repairs. Do not remove any components or service panels on this product.
- Never bypass, alter, modify, or attach any unauthorized parts to this equipment. Doing so may create a hazard and will void warranty.
- We take every care to ensure that all products are safe. Steel cutting procedures used to manufacture these items result in sharp edges. These sharp edges are removed to the best of our ability; however, we insist the operator take care when in contact with this piece of equipment.
- Always keep hands, hair, and clothing away from heating source.

DOUBLE DECK STACKING STRUCTIONS

Double-deck ovens are shipped as single deck ovens and must be assembled on site by the installer. Ovens shipped as single deck oven can be stacked in the field (additional parts are required.) This installation step describes the procedure for stacking tow single-deck ovens to form a double-deck oven.

- Uncrate both ovens in the area to be stacked. Identify with of the oven will be on the bottom. Attached either the legs or casters that are in the Stacking Kit to the bottom oven as shown below.
- Remove flue assembly from both top and bottom oven.
- Carefully lift top oven onto the bottom aligning the top and bottom locator holes.
- Install stacking bracket as shown. This will prevent the top oven from moving on the bottom oven.

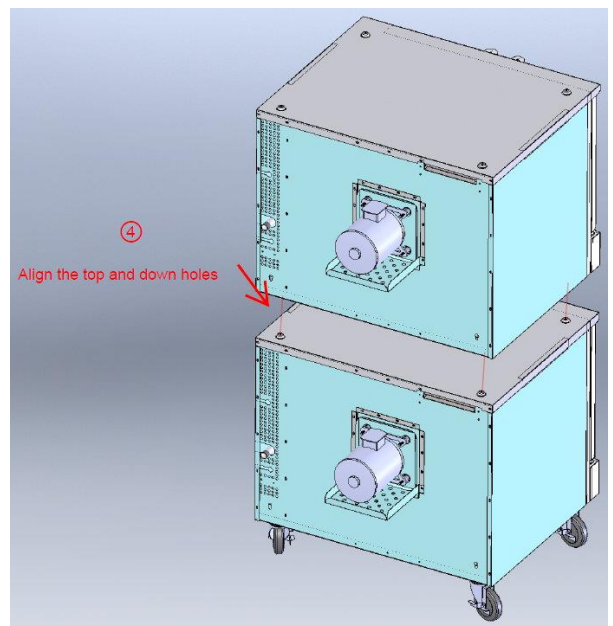
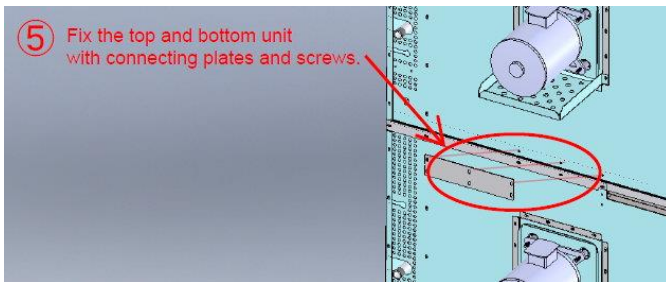
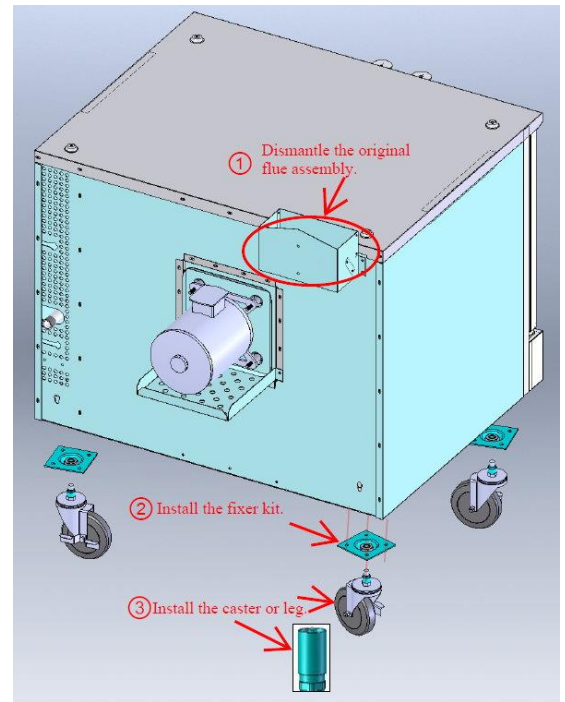

Install flue riser to both ovens. *Note: If not installed correctly or not at all warranty will be void.

- If you choose to make one gas connection, it is recommended that a minimum of a 1" NPT connection be made. Otherwise, two (2) 3/4" NPT connections will be required.

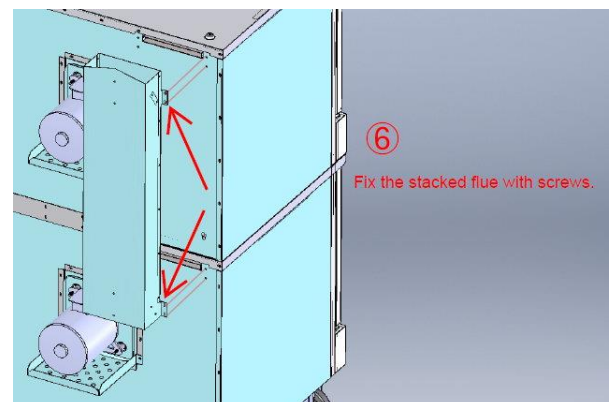

OPERATING INSTRUCTIONS

Lighting, Relighting, and Shutdown Instructions

- To light the oven, just switch the power switch at the top left corner of the control panel to the “ON” position. (The oven is equipped with a direct hot surface ignition system. There is no pilot to light.)
- If the burners fail to ignite within four seconds, the oven will automatically shut off the gas, wait five minutes to allow the gas that was released to dissipate, and try to light the burners again. If the burners still fail to ignite after three such attempts, the oven will stop trying, even though the power switch is in the “ON” position. To continue to attempt to light the burners, turn the power switch “OFF” and then “ON” again.
- To shut down the oven, switch the power switch to the “OFF” position. For a complete shutdown, also open the control panel and turn the manual shut-off valve to the “OFF” position.

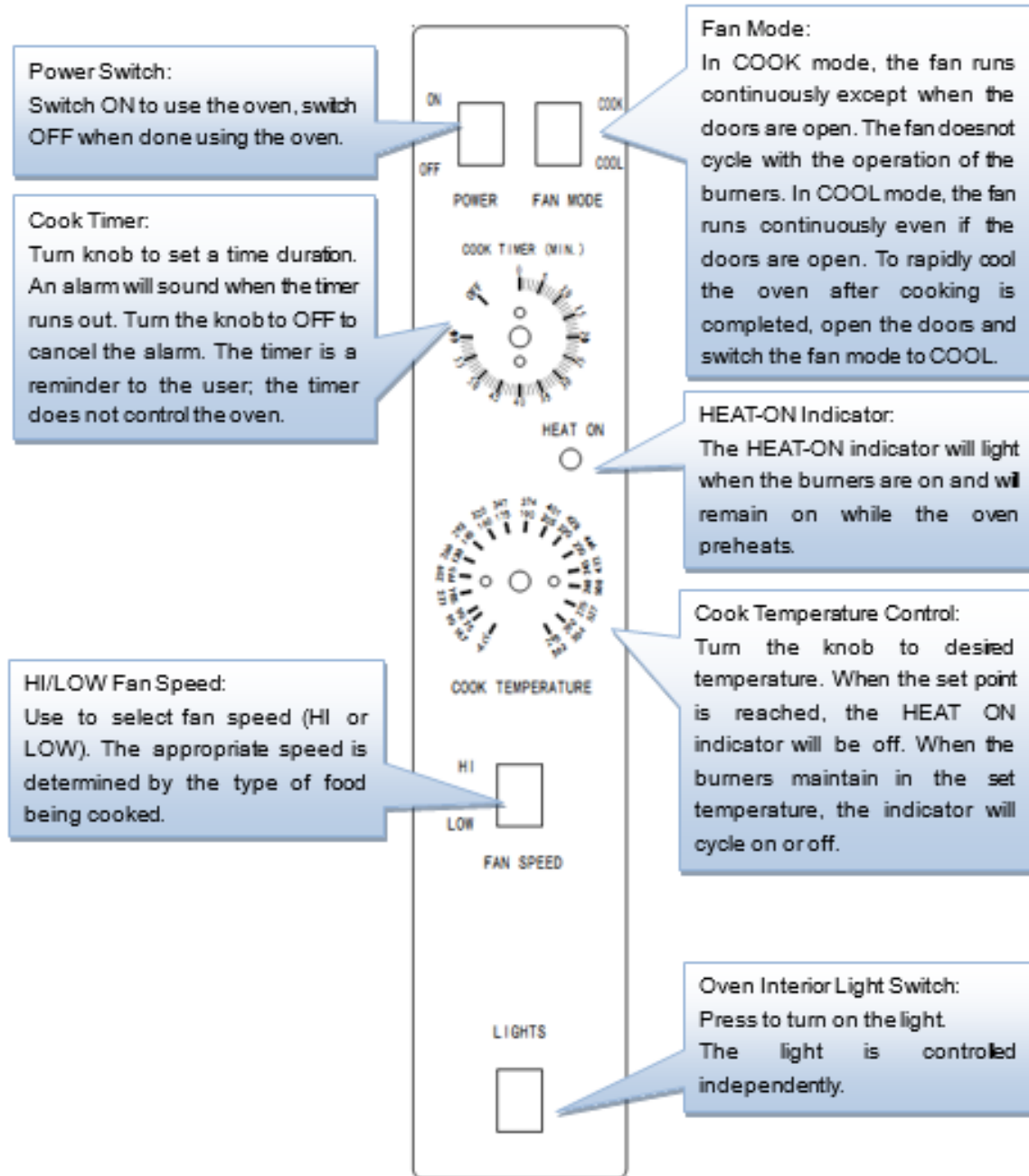

Operating the Controls

A convection oven is a different type of oven that offers many features and advantages to the food service operation. The additional capabilities and features of the oven require some learning. However, the operation of the oven is not difficult to understand or control once you have some practice. See the controls in the following feature:

Operations

Turn the oven ON and select a cooking temperature. Two additional controls are used to control the fan (as described below). The timer is a reminder to you of when to remove food from the oven. The timer does not control the temperature of the oven.

To cook, do the following:

1. Turn the oven ON using the Power Switch at the top of the control panel.
2. Select the desired fan speed using the Fan Speed switch. The appropriate fan speed (HI or LOW) depends on the type of food being cooked.
3. Switch the Fan Mode switch to COOK. The fan will run continuously when the oven doors are closed (the fan does not cycle on and off with the burners). (If this switch is set to COOL, the only difference is that the fan will continue to run when the oven doors are open.)
4. Set the cooking temperature by turning the Cook Temperature Control until the indicator mark on the knob is pointed to desired cooking temperature. The HEAT ON indicator will light when the burners are on and will remain on while the oven preheats.
5. Wait until the HEAT ON indicator has come on and gone out three times. At that time the oven will have reached the set cooking temperature.
6. Open the oven doors, load the product into the oven, and close the doors.
7. You can use the Cook Timer as a reminder of when to remove the load from the oven. If so desired, turn the Cook Timer knob until the indicator mark points to the desired cooking time (up to 55 minutes). The timer knob will rotate counterclockwise as the timer runs down, indicating how much time remains. You can turn the knob while cooking to increase or decrease the remaining time. When the timer runs out, a buzzer will sound for a short time, then turn itself off. (To immediately silence the buzzer, turn the Cook Timer knob to the OFF position.) The timer is a reminder to you; the timer does not control the oven. If you open the oven doors, the burners and fan will shut off until the doors are closed. However, the timer will continue running even if the doors are open. For ovens that are equipped with an oven interior light, to turn on the light, press and hold the switch located at the bottom of the control panel.
8. When the load has finish cooking, you can rapidly cool the load by opening the oven doors (which will shut off the burners) and switching the Fan Mode to COOL (which will cause the fan to run even though the doors are open). For the most rapid cooling, also switch the Fan Speed switch to HI.
9. When you are done cooking, turn the FAN MODE switch to cool and allow the oven to operate with the doors open for approximately 20 to 30 minutes to cool. This will prolong the life of the convection oven fan motor. Once cool then turn Power Switch to OFF.

CLEANING & MAINTENANCE INSTRUCTIONS



FOR YOUR SAFETY, DISCONNECT THE ELECTRICAL POWER SUPPLY TO THE APPLIANCE BEFORE CLEANING. WHEN CLEANING THE CONVECTION OVEN BLOWER WHEEL, BE SURE TO THE POWER SWITCH TO THE OFF POSITION.

1. Before cleaning, be sure the oven is cool and the power switch is in the off position.
2. Carefully clean daily the appliance to guarantee its proper operation and long life. Remove the oven-interior racks and rack slide frames. (The rack slide frames are readily removable by merely raising to disengage them from their sockets.) Wash the racks and rack slides in a sink with mild detergent and warm water. Dry them thoroughly with a clean cloth.
3. Look to see if any foreign matter has accumulated in the blades of the blower wheel, (particles of aluminum foil is very common of this.), the debris in the blower wheel will reduce the air flow circulation inside the oven as a result will be poor back performance. Use a stiff brush to remove debris and baked on matter from the blade of the blower wheel. Then was with soap and water.
4. Wash the interior surfaces with mild detergent and warm water. Rinse thoroughly with clean water. For stubborn/baked on debris a commercial oven cleaner may be used. Do not use steel wool in the interior of the oven, particles of the steel wool could be left behind and my contaminate food product. Scotch-brite® pads or alike that are non-metallic may be used.

MONTHLY CLEANING

- Clean around the rear of the oven, especially the rear of the motor. Be sure the cooling vents are not blocked with lint or debris. If so, use a stiff bristle brush to clean.

CLEANING STAINLESS STEEL SURFACES

On the stainless front or interiors, deposits of baked on splatter may be removed with any non-toxic industrial stainless steel cleaner. Heat tint and heavy discoloration may be removed with any non-toxic commercial oven cleaner.

- Apply cleaners when the oven is cold. Always rub with the grain of the metal. Never in a circular direction
- To remove heat tint or darkened areas can be removed by the vigorous scouring in the direction of the polish line or "grain" of the stainless. Using Scotch-Brite® pads in combination with powdered cleanser.

Electrical Wire Diagram:

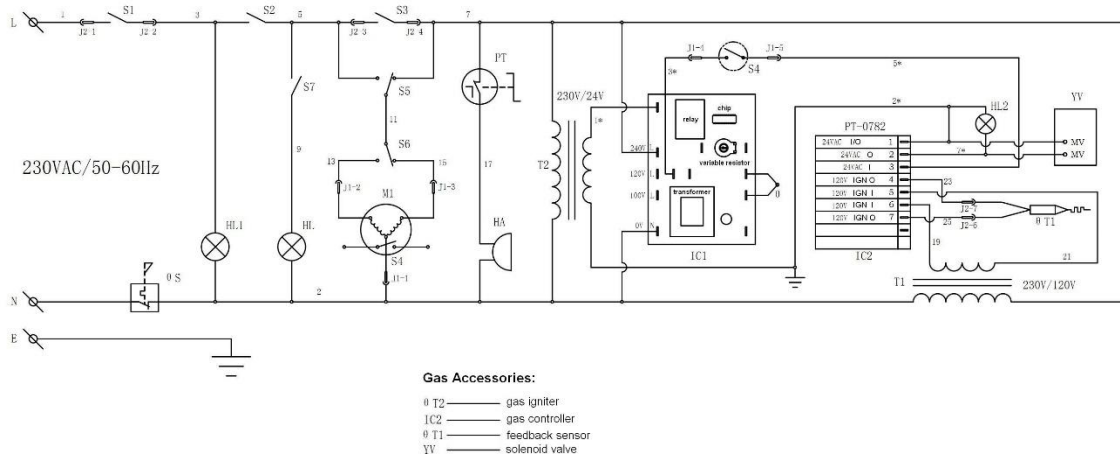

Page intentionally left blank.

PARTS LIST

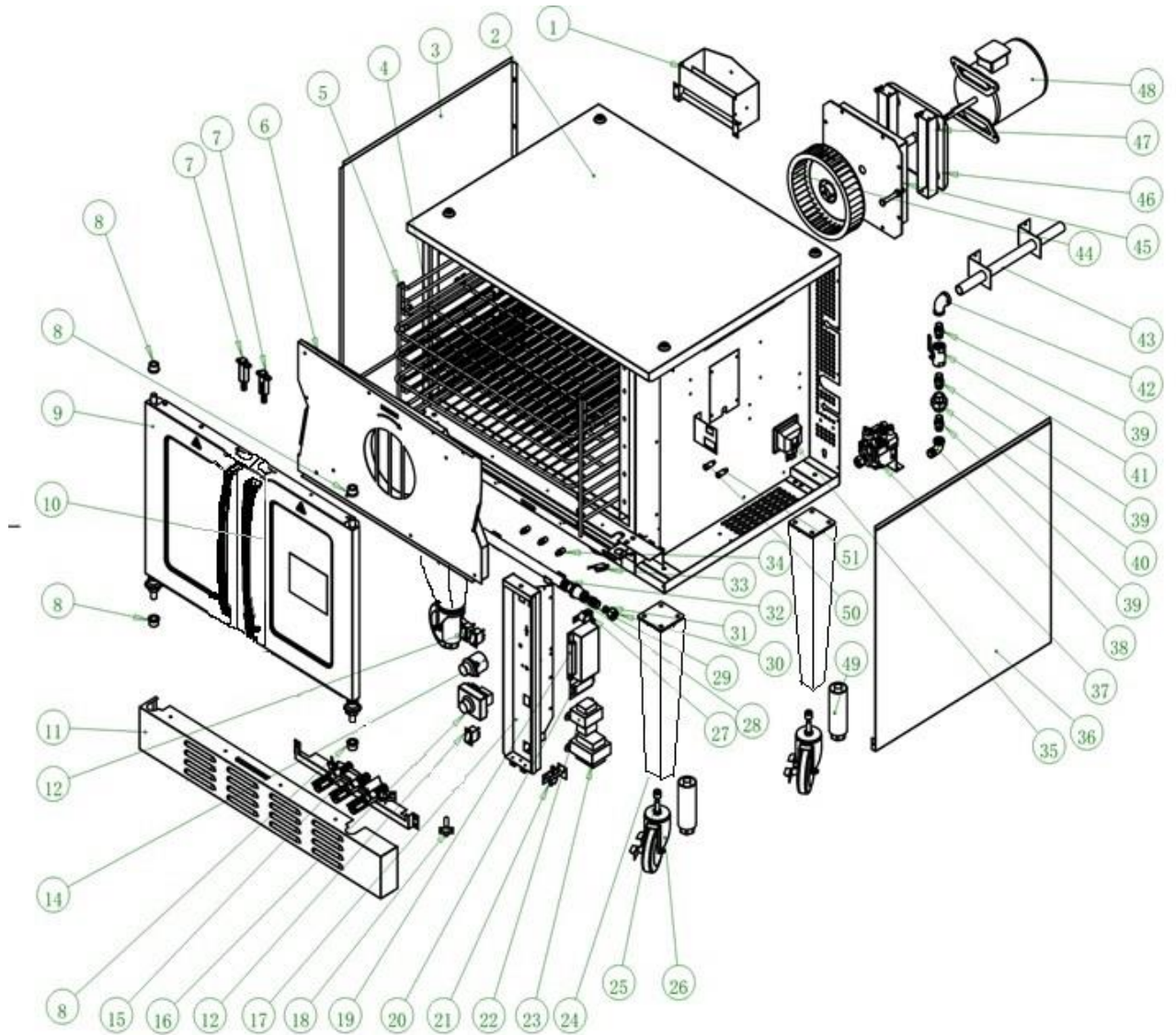

NO.	PART #	DESCRIPTION	QTY
1	FGC10001	REAR FLUE	1
	FGC10050	REAR FLUE (DOUBLE STACK)	*
2	N/A	HOUSING ASSEMBLY UNIT	1
3	FGC10002	LEFT SIDE PANEL	1
4	FGC10003	RACK	5
5	FGC10004	RACK HOLDER	2
6	FGC10005	CONVECTION/HOT AIR COMPARTMENT ASSEMBLY	1
7	FGC10006	DOOR STOPPER ASSEMBLY	2
8	FGC10007	DOOR SHAFT BUSHING	6
9	FGC10008	LEFT DOOR ASSEMBLY	1
10	FGC10009	RIGHT DOOR ASSEMBLY	1
11	FGC10010	LOWER FRONT COVER PLATE	1
12	FGC10011	WATER-PROOF SWITCH	3
14	FGC10012	TIMER	1
15	FGC10013	BURNER ASSEMBLY	1
16	FGC10014	THERMOSTAT	1
17	FGC10015	CONTROL PANEL ASSEMBLY	1
18	FGC10016	HOT SURFACE IGNITER	1
19	FGC10017	IGNITION CONTROLLER	1
20	FGC10018	TERMINALS	1
21	FGC10019	DOOR SWITCH	2
23	FGC10020	TRANSFORMER	1
24	FGC10021	LEG ASSEMBLY	4
25	FGC10022	CONNECTOR	4
26	FGC10023	CASTER	4
27	FGC10024	BUZZER	1
28	FGC10025	STRAIGHT TUBE	1
29	FGC10026	CONNECTOR	2
30	FGC10027	NUT	2
31	FGC10028	HOOP	2
32	FGC10029	MANIFOLD	1
33	FGC10030	MICRO SWITCH	1
34	FGC10051	MAIN BURNER ORIFICE NAT (2.0 MM)	3
34	FGC10052	MAIN BURNER ORIFICE LP (1.25 MM)	3
35	FGC10032	BULB/LAMP HOLDER ASSEMBLY	1
36	FGC10033	RIGHT SIDE PANEL	1
37	FGC10034-N	SAFETY VALVE NATURAL	1
37	FGC1034-P	SAFETY VALVE PROPANE	*
38	FGC10035	ELBOW	1
39	FGC10036	STRAIGHT TUBE	3
40	FGC10037	UNION	1
41	FGC10038	BALL VALVE	1
42	FGC10039	ELBOW	1
43	FGC10040	GAS INLET PIPE	1
44	FGC10041	BLOWER WHEEL	1
45	FGC10042	HEAT SHIELD ASSEMBLY	1
46	FGC10043	MOUNTING CONTOUR POST	4
47	FGC10044	INSULATION PAD	4
48	FGC10049	MOTOR ASSEMBLY W/ BLOWER WHEEL	1
49	FGC10046	Adjustable Leg	4
51	FGC10047	INDICATOR LIGHT	1
*	FGC10053	CONVERSION KIT NAT TO LP	
*	FGC10043	CONVERSION KIT LP TO NAT	

GAS COOKING EQUIPMENT WARRANTY (NON-TRANSFERABLE)

All new Entrée Gas Cooking Equipment is warranted to be free from defects in material and workmanship under normal use and service for a period of one (1) year from the date of original purchase, or 20 months after shipment date from the manufacturer, whichever occurs first. Any gas cooking equipment installed in a non-permanent structure, such as a mobile kitchen and/or trailer shall have a thirty (30) days limited warranty from the date of purchase. Proof of purchase required. Intended for indoor commercial use only.

This is limited to the repair and replacement, including labor charges of defective parts and/or assemblies. Labor, travel and mileage covered for the first year include straight time labor charges and travel charges within 100 miles, roundtrip.

1. This warranty is limited to original installation of new Entrée Gas Cooking Equipment for the original user in the United States or Canada. This warranty is not transferable.
2. This warranty does not apply to any equipment that has not been installed in accordance with the directions published in the appropriate installation and operation manuals.
3. Entrée will bear no responsibility or liability for any equipment which has been mishandled, abused, misapplied, misused, subjected to harsh chemical action, or external causes such as gas fluctuations, field modified without the approval of Entrée, or by unauthorized personnel, improperly installed or maintained, equipment damaged by flood, fire, or other acts of God, or which have altered or missing serial numbers.
4. This warranty applies only to defects in parts and workmanship in equipment and not damage incurred in shipping or handling.
5. If the equipment has been changed, altered, modified, or repaired with parts not authorized or by a nonqualified Entrée Service Technician, then Entrée shall not be responsible for warranty claim.
6. Adjustments such as calibrations, leveling, tightening of fasteners, or utility connections normally associated with original installation are the responsibility of installer and not that of Entrée. Regular maintenance and cleaning shall be the responsibility of the customer.
7. Entrée will bear normal labor charges incurred in the repair or replacement of a warranted piece of equipment within 50 miles of an authorized service agent. Overtime, premium labor charges and travel charges in excess of 100 miles round trip will not be covered by Entrée and will be the responsibility of the person or firm requesting the service.
8. Original purchased replacement parts will be warranted for 90 days from the parts invoice date. This warranty is for parts cost only and does not include freight or labor charges.
9. This warranty provides the exclusive remedy against Entrée relating to all Entrée, whether in contract or in tort or under any other legal theory and whether arising out of warranties, representations, instructions, installations, or defects from any cause. Entrée shall not be liable, under any legal theory, for loss of use, revenue or profit, or for substitute use or performance, or for incidental, indirect, or special or consequential damages, or for any other loss of cost of similar type. The laws of some jurisdictions limit or do not allow the disclaimer of consequential damages. If the laws of such a jurisdiction apply to any claim by or against Entrée, NO limitations and disclaimers contained here shall be the greatest extent permitted by law.
10. The liability of Entrée is limited to the repair or replacement of any part found to be defective.
11. **This unit is factory supplied in Natural Gas or LP Gas.** This unit can be converted by a licensed and certified gas technician. Documentation may be necessary for warranty issues. Failure to comply with this instruction will void warranty.

THIS WARRANTY AND THE LIABILITIES SET FORTH HEREIN ARE EXCLUSIVE AND IN LIEU OF ALL OF THEIR LIABILITIES AND WARRANTIES, EXPRESS OR IMPLIED, INCLUDING BUT NOT LIMITED TO, IMPLIED WARRANTIES OF MERCHANTABILITY AND FITNESS FOR PARTICULAR PURPOSE AND CONSTITUTES THE ONLY WARRANTY OF ENTRÉE WITH RESPECT TO THE PRODUCT(S). ENTRÉE LIABILITY ON ANY CLAIM, INCLUDING BUT NOT LIMITED TO NEGLIGENCE, SHALL NOT EXCEED THE PRICE OF THE EQUIPMENT THAT GIVES RISE TO THE CLAIM.

WARRANTY CLAIMS

All requests for must be called into 866-417-6140 to obtain and agree to service dispatch with Warranty Claim Payment Terms. All claims for labor or parts must be made directly through Entrée L.L.C.

All claims should include: Dispatch number, model number of the unit, the serial number of the cabinet, proof of purchase, date of installation, and all pertinent information supporting the existence of the alleged defect.

WHAT IS NOT COVERED BY THIS WARRANTY

Entrée L.L.C. sole obligation under this warranty is limited to either repair or replacement of parts, subject to the additional limitations below. This warranty neither assumes nor authorizes any person to assume obligations other than those expressly covered by this warranty. Travel beyond 50 miles round trip and more than 2 hours round trip.

NO CONSEQUENTIAL DAMAGES. ENTRÉE L.L.C. IS NOT RESPONSIBLE FOR ECONOMIC LOSS; PROFIT LOSS; OR SPECIAL, INDIRECT, OR CONSEQUENTIAL DAMAGES, INCLUDING WITHOUT LIMITATION, LOSSES OR DAMAGES ARISING FROM FOOD OR PRODUCT SPOILAGE CLAIMS WHETHER OR NOT ON ACCOUNT OF REFRIGERATION FAILURE.

WARRANTY IS NOT TRANSFERABLE. This warranty is not assignable and applies only in favor of the original purchaser/user to whom delivered. **ANY SUCH ASSIGNMENT OR TRANSFER SHALL VOID THE WARRANTIES HEREIN MADE AND SHALL VOID ALL WARRANTIES, EXPRESS OR IMPLIED, INCLUDING ANY WARRANTY OF MERCHANTABILITY OR FITNESS FOR A PARTICULAR PURPOSE. IMPROPER USAGE. ENTRÉE L.L.C. ASSUMES NO LIABILITY FOR PARTS OR LABOR COVERAGE FOR COMPONENT FAILURE OR OTHER DAMAGES RESULTING FROM IMPROPER USAGE OR INSTALLATION OR FAILURE TO CLEAN AND/OR MAINTAIN PRODUCT AS SET FORTH IN THE OWNER'S MANUAL PROVIDED WITH THE UNIT.**

RELOCATION OF EQUIPMENT FOR REPAIR: Entrée L.L.C. is not responsible for the cost to move the unit for any reason from its position of operation on the customer's premises to make a warranty repair.

RESIDENTIAL APPLICATIONS: Entrée L.L.C. assumes no liability for parts or labor coverage for component failure or other damages resulting from installation in non-commercial or residential applications.

ALTERATION, NEGLIGENCE, ABUSE, MISUSE, ACCIDENT, DAMAGE DURING TRANSIT OR INSTALLATION, FIRE, FLOOD, ACTS OF GOD.

Entrée L.L.C. is not responsible for the repair or replacement of any parts that Entrée L.L.C. determines have been subjected after the date of manufacture to alteration, neglect, abuse, misuse, accident, damage during transit or installation, fire, flood, or act of God.

IMPROPER GAS CONNECTIONS. ENTRÉE L.L.C. IS NOT RESPONSIBLE FOR THE REPAIR OR REPLACEMENT OF FAILED OR DAMAGED COMPONENTS RESULTING FROM INCORRECT PRESSURE OR TYPE OF GAS. THIS EQUIPMENT IS INTENDED FOR INDOOR USE ONLY.

NO IMPLIED WARRANTY OF MERCHANTABILITY OR FITNESS FOR A PARTICULAR PURPOSE: THERE ARE NO OTHER WARRANTIES, EXPRESSED, IMPLIED OR STATUTORY, EXCEPT THE ONE (1) YEAR PARTS & LABOR WARRANTY. THESE WARRANTIES ARE EXCLUSIVE AND IN LIEU OF ALL OTHER WARRANTIES, INCLUDING IMPLIED WARRANTY AND MERCHANTABILITY OR FITNESS FOR A PARTICULAR PURPOSE. THERE ARE NO WARRANTIES WHICH EXTEND BEYOND THE DESCRIPTION ON THE FACE HEREOF.

OUTSIDE U.S.: This warranty does not apply to, and Entrée L.L.C. is not responsible for, any warranty claims made on products sold or used outside the United States and Canada.

GAS CONVECTION OVEN



ENTRÉE LLC
4673 Osborne Dr. Suite 1
El Paso TX 79922

For Warranty Service (866)417-6140
Technical Support 570-752-4602
www.entree.biz

Register your product warranty online at: www.entree.biz

A product with the Entrée name incorporates the best in durability and low maintenance. We all recognize, however, that replacement parts and occasional professional service may be necessary to extend the useful life of this unit. When service is needed, contact an Entrée Authorized Service Agency, or your dealer. To avoid confusion, always refer to the Model Number, Serial Number, and Type of your unit.



Conforms to ANSI
STD Z83.11b
Certified to CSA
STD 1.8b
Conforms to
NSF/ANSI STD 4